

Smart Wi-Fi Door Lock



Visit www.tapo.com/support

for technical support, user guides, warranty,
and more information



Quick Start Guide



Welcome to Tapo!

Installation Guide & Video

Scan QR code or visit
<https://www.tp-link.com/support/faq/4335/>



Contact Us

Our expert Technical Support team is ready to assist you. Please don't hesitate to reach out with any questions.



EMAIL



CHAT



CALL

<https://www.tp-link.com/support/contact-technical-support/>



Contents

Parts in the Box	— — — — — — — — — —	1
Installation Preparation	— — — — — — — —	5
Installation	— — — — — — — — — —	8
Setup	— — — — — — — — — —	20
How to set the PIN code	— — — — — — —	22
What if the battery is dead while you are outside?	— — — — — — —	23
Appearance	— — — — — — — — — —	24

Parts in the Box

Install the Bolt & Strike Plate

Packaged Together

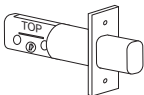

Bolt



Strike Plate



Dust Box

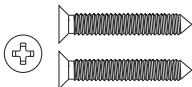

Bolt Screws
(ST4*25)×2

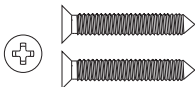

Strike Plate Screws
(ST4*25)×2

Install Exterior Assembly



Installation
Reference Line
Sticker for
Exterior Assembly

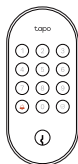

Exterior
Assembly

Install Interior Assembly

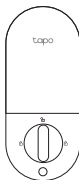

Interior
Assembly

Actual Size

(M4*7.5)×3

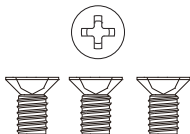

Install the Interior Mounting Plate

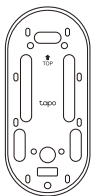

Mounting
Plate



Installation
Reference Line
Sticker for Interior
Assembly

Actual Size

(M4*32)×2

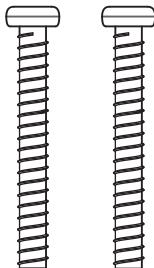

Others



AA/LR6
Batteries ×4



Keys ×2



Silicone
Cover

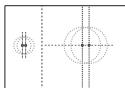

Measuring
Template



Quick Start
Guide

Installation Preparation

Check Compatibility

1. Check your existing door lock type.



Compatible with Single
Cylinder Deadbolt

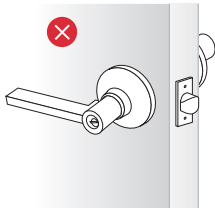

Lever Handle Lock Not
Compatible

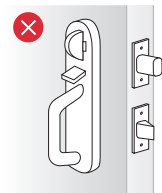

Integrated Locks
Not Compatible

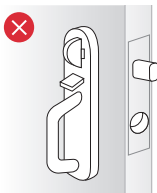

Mortise Locks
Not Compatible

2. Measure your door.

Place the measuring template on the door, aligning its door edge line with the door edge.

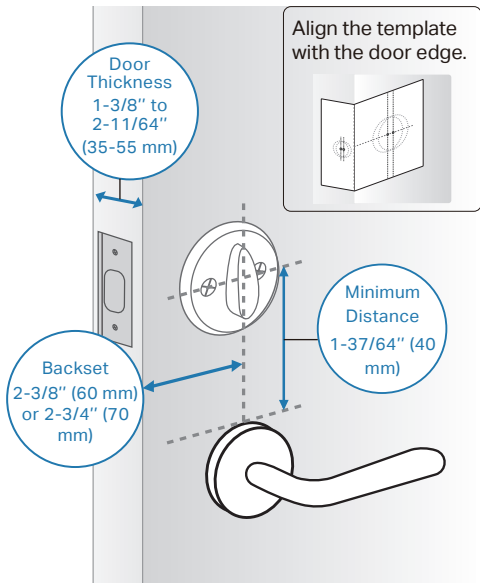

Installation

Installation Overview

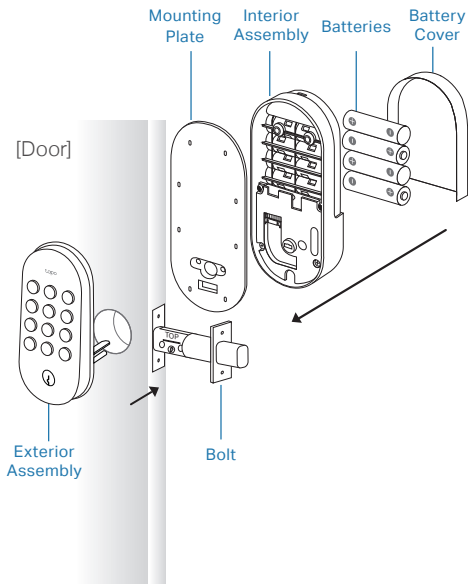

1 Remove your existing lock.

Remove your existing door lock and bolt.

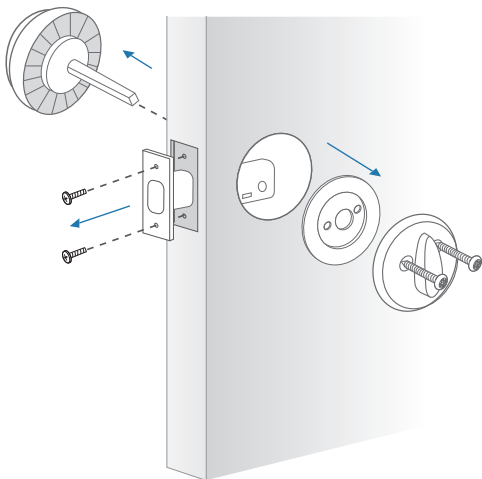

2 Install the new bolt.

- A** Ensure the word **TOP** is facing up.

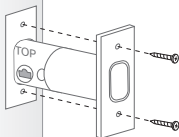
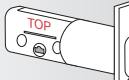

- B** If the latch hub is not centered in the door hole, twist the bolt to extend it.

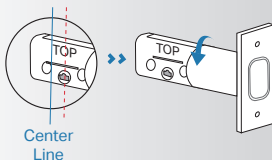

Bolt Screws

Packaged together with the bolt

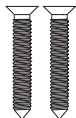

3 Install the exterior assembly.

- A** Place the **exterior assembly sticker** on the outside door by aligning its door edge line with your door edge.

Note: Choose the door edge line based on your backset distance.



- B** Cable goes under the bolt.

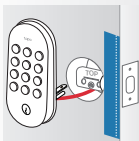

[OUTSIDE]

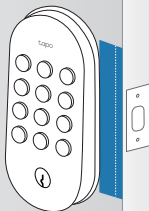

- C** Insert the tailpiece and two prongs into the corresponding holes on the bolt and align the exterior assembly with the sticker.

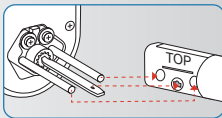

4

Install the mounting plate.

- A** Place the **interior assembly sticker** on the inside door by aligning its door edge line with your door edge.

Note: Choose the door edge line based on your backset distance.

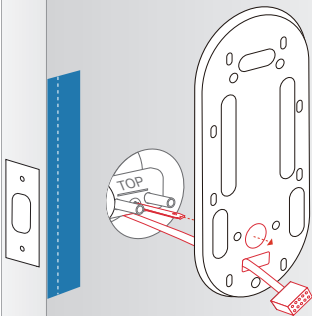
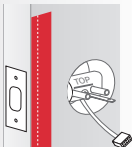

- B** Route the cable through the mounting plate's rectangular hole and insert the tailpiece into the center round hole.

- C** Align the mounting plate with the sticker, ensuring the two prongs of the exterior assembly match the two holes next to the center round hole. Secure it with the screws.

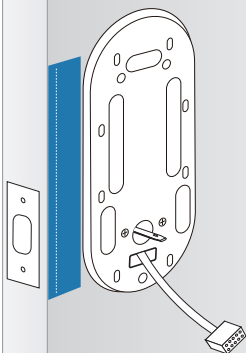
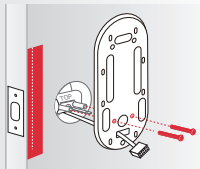

5 Install the interior assembly.

[INSIDE]

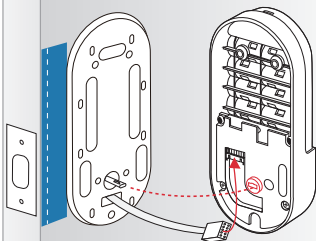

- A** Remove the battery cover.

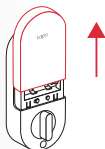

- B** Connect the cable tightly. Ensure the color side faces up.

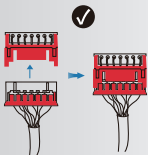

Red marking facing up

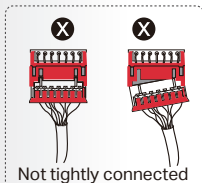

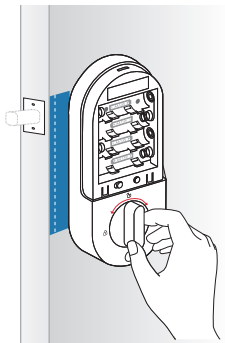
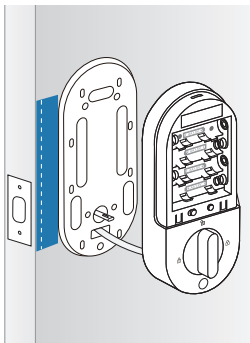

- C** Align the tailpiece with the key cylinder. Attach the interior assembly to the mounting plate.

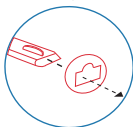

- D** Rotate the thumb latch to ensure the latch retracts normally.

- E** Use the **three** provided M4*7.5 screws to affix the interior assembly.

M4*7.5 Screws

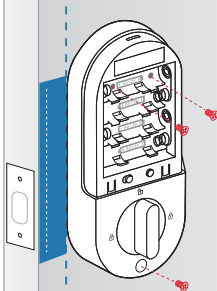

6 Install the batteries.

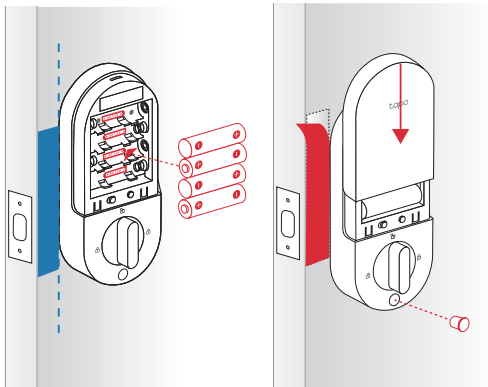

A Insert the batteries into the interior assembly, ensuring the positive and negative terminals are oriented correctly.

B Replace the cover by sliding it down. Insert the silicone cover into the bottom hole. Remove the stickers.

7 Install the dust box & strike plate.

Insert the dust box and strike plate into the strike hole on the door frame and secure with screws. Ensure the depth of the strike hole is at least 1" (25.4 mm).

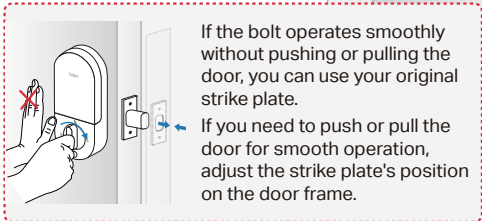
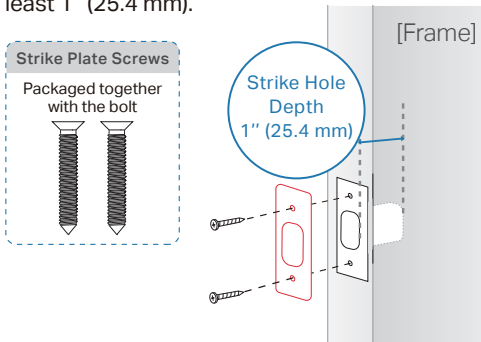

Setup

Set Up Your Lock

1. Get the **Tapo** app from the App Store or Google Play and log in with your TP-Link ID. If you do not have an account, create one first.



2. Tap the \oplus button in the app. Select **Door Locks** and then your model. Follow the app instructions to complete setup.

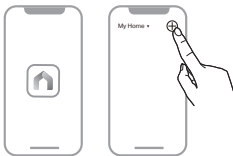

The Tapo app is needed to use this lock. If this lock was professionally installed (or installed by someone other than the homeowner), make sure this step was performed by the homeowner.

How to set the PIN code

The PIN code should be set in the Tapo app.
Tapo will guide you to set your access code.



What if the battery is dead while you are outside?

- **Unlock via the provided key**

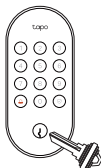

- **Temporarily power up the lock**

Connect to a power outlet or power bank using a USB cable to provide a temporary power supply. Note that this port is for power only and cannot transfer data.

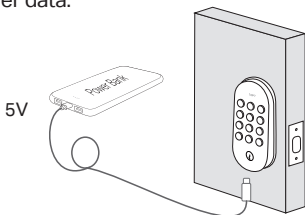

Appearance

Appearance

Exterior Assembly

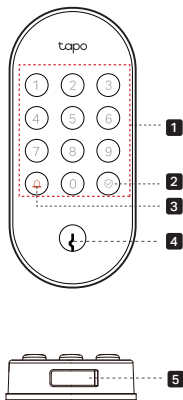

1 Key Pad

Lock/unlock the door by entering your PIN code.

2 Lock/Unlock Button & Indicator

Button:

- When entering the PIN code with scrambled digits, press this button to confirm unlocking.
- When the door is unlocked, press this button to lock it.

Indicator:

Indicates the lock/unlock status and device status.

3 Ring Button

When this button is pressed, you will receive notifications in the app.

4 Lock Cylinder

Unlock via the provided keys.

5 5V Type-C Port

Connect to a power outlet for a temporary power supply.

Interior Assembly

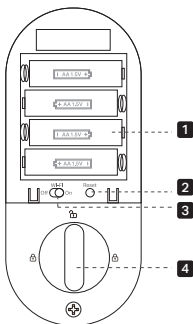

1 Battery Compartment

Insert the provided batteries to power your lock.

2 Reset

- Press and hold for 5s to reset Wi-Fi settings.
- Press and hold for 10s to factory reset your device.

3 Wi-Fi On/Off Button

Turn on Wi-Fi and connect to a Wi-Fi network for remote control.

Turn off Wi-Fi and only control locally via Bluetooth.

Note: When Wi-Fi is toggled off, sync the time in the app every time you replace the batteries.

4 Thumb Latch

Rotate to lock/unlock the door.

Lock/Unlock Indicator

 Indicator Display	Situation
Solid blue	Being unlocked; Unlocking successful
Solid yellow	Being locked; Locking successful
Solid red	Locking/unlocking failed
Solid red	Door lock jammed; Too many PIN code attempts
Blinking red and green	Ready for setup

Specifications

Type-C Emergency Power Supply: 5V 

Batteries: 4× 1.5V SIZE AA/LR6

Rainproof Rating: IP54 (only for the exterior assembly)

Safety Information

- Do not attempt to disassemble, repair, or modify the device. If you need service, please contact us.
- Do not use the device where wireless devices are not allowed.
- Keep the device away from water, fire, humidity or hot environments.
- Do not place near automatically controlled devices such as fire alarms. Radio waves emitted from this product may cause such devices to malfunction resulting in an accident.
- Observe restrictions on using wireless products in fuel depots, chemical plants or when blasting operations are in progress.
- Never put metal objects inside the product. If a metal object enters the product turn off the circuit breaker and contact an authorised electrician.
- This product is not intended to be used when providing medical care. Consult the manufacturer of any personal medical devices, such as pacemakers or hearing aids to determine if they are adequately shielded from external RF (radio frequency) energy.
- Do not use this product in health care facilities. Hospitals or health care facilities may be using equipment that could be sensitive to external RF energy.
- Ensure to use a power bank or 5V power adapters when temporarily powering up the device.
- When the interior room temperature is below 0°C, the device may not be unlocked using PIN codes due to the limited battery discharge capacity of AA/LR6 Alkaline batteries.
- Exterior Assembly Operating Temperature: -30 °C ~ 70°C (-22°F ~ 158°F)

Please read and follow the above safety information when operating the device. We cannot guarantee that no accidents or damage will occur due to improper use of the device. Please use this product with care and operate at your own risk.

CAUTION!

Risk of fire or explosion if the battery is replaced by an incorrect type

CAUTION!

Avoid replacement of a battery with an incorrect type that can defeat a safeguard. Avoid disposal of a battery into fire or a hot oven, or mechanically crushing or cutting of a battery, that can result in an explosion. Do not leave a battery in an extremely high temperature surrounding environment that can result in an explosion or the leakage of flammable liquid or gas. Do not leave a battery subjected to extremely low air pressure that may result in an explosion or the leakage of flammable liquid or gas.

*Images may differ from your actual product.